

Two-way thermostat

- Opening temperature according to customer request
- Unique designed characteristic
- Common developement with customer
- Brass material for faster reaction
- Optionally vibration damper and/or gasket

Opening temperature	Temperature of full opening	Max stroke
42°C	60°C	8 mm

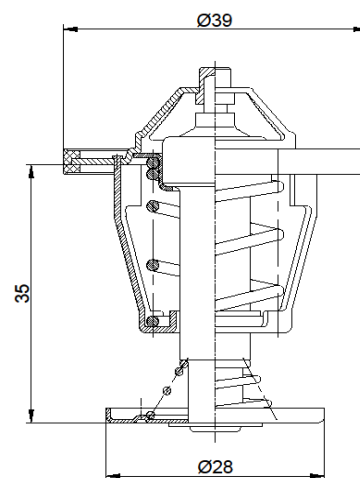

Technical parameters

Maximum permissible temperature	+120°C
Possible operation range	+25–95°C
Possible flow rate	500–2000 ml/perc
Vibration damper	no
Gasket	optional